

1. Components



A. Smart controller B. 120-240V AC - 15V DC power adapter (1000mA) C. External RJ14 Network cable

D. 2x Temperature/ humidity sensor with cable (5m/16ft) E. 2x Countersunk screw F. 2x Plug

2. Connections

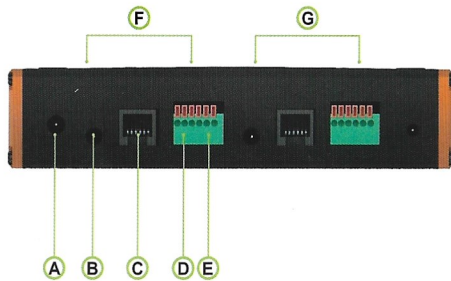

CONNECTIONS	
A	5V DC input
B	3.5mm jack aux temperature/ humidity sensor
C	RJ14 aux port for controlling up to 160pcs fixtures
D	Relay switch controlled by temperature/ humidity sensor
E	Relay switch controlled by temperature/ humidity sensor
F	Zone A
G	Zone B . same functions as Zone A

3. Preparations

Mount the fixtures or ballasts as per your lighting plan.
Make sure the rotary knob on all ballasts is set to "EXT" (external control).
Connect the ballasts or fixtures to the mains

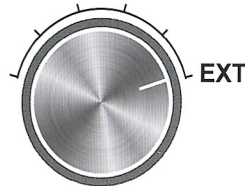

4. Power supply and initial setting

a. Mount controller onto a secure surface using the screws supplied with the controller.
Notice: Make sure the controller away from heat sources.
The distance between the center of each mount hole is 10cm

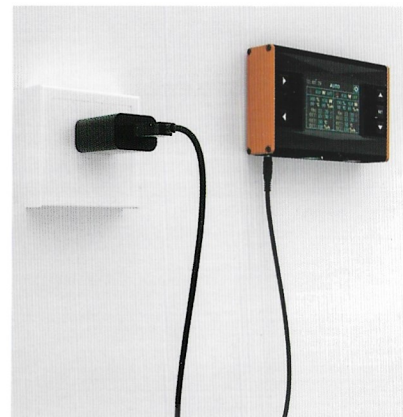

b. Connect the power cord into the smart controller and power source.

5. Information of temperature and humidity sensor and Installation:

Connect the temperature and humidity sensor plug into the smart controller temperature and humidity sensor port in Group A. Hang the sensor at canopy height making sure the sensor and cord are hung and routed away from direct heat sources.
Repeat install with port in Group B, if necessary.

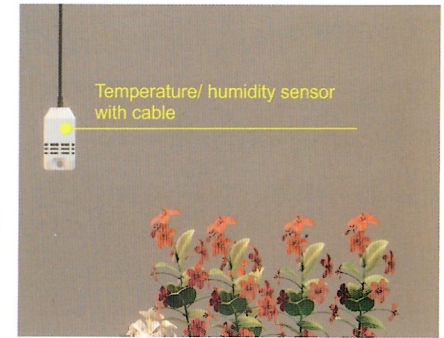

6. Connecting the smart controller to light fixtures:

Connect one end of the RJ14 cord to the smart controller A port, the other end to the A port



SMART CONTROLLER

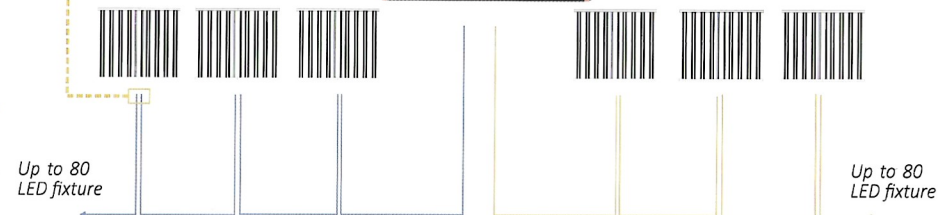

7. Controls

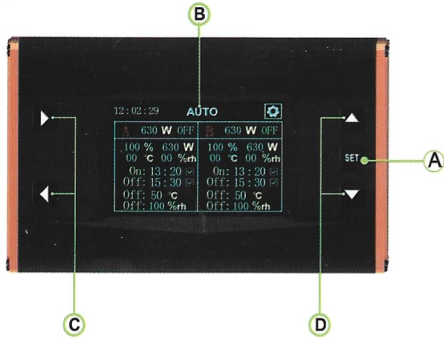

CONTROLLERS		
	Key	Function
A	Set	To get cursor(long press)/Confirm(short press)
B	Display	Display status and controller menu
C	Right/Left	Move cursor
D	Up/Down	Change the Value

8. TOUCH "Setting" to get

a. Customized wattage & dimming percentage

b. Help Tips

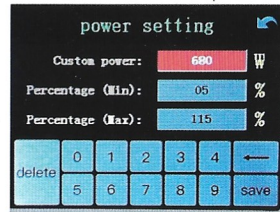
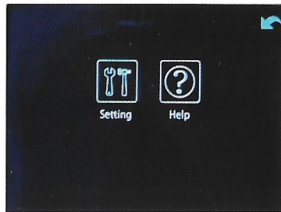

9. Setting up the controller

Long press "SET" for 3 seconds until the red highlighted area appears, ready to control.

12:02:29		AUTO		⚙️	
A	680 W OFF	B	1000 W OFF		
100 %	630 W	100 %	630 W		
00 °C	00 %rh	00 °C	00 %rh		
On: 13:20	☑	On: 13:20	☑		
Off: 15:30	☑	Off: 15:30	☑		
Off: 50 °C		Off: 50 °C			
Off: 100 %rh		Off: 100 %rh			

Sunrise / Sunset Timing Setup

Temperature and Humidity Setup

⚠️ SAFTY WARNING

- 1.Keep the smart controller in a cool and dry environment, away from dust, dust, heat and moisture.
- 2.Make sure all RJ and power cords are safely routed away from heat, moisture, mechanical movement or any thing that may damage cords.
- 3.Do not use abrasives, acids or solvents to clean master controller. Use a soft, dry cloth to clean controller.
- 4.Do not attempt to disassemble or repair the master controller. This will void controller warranty
- 5.Smart controller are designed to work with GC RJ14 data cords. Using other brand or non-RJ14 data cords could cause malfunctions and may void warranty

Notice: THIS PRODUCT CONTAINS A BATTERY AND OTHER MATERIALS, WHICH MUST BE DISPOSED OF PROPERLY AND IN A LAWFUL WAY, THROUGH AN ELECTRIC RECYCLING CENTER.

HY SMART CONTROLLER

Lighting control at your fingertips!



Product Advantage

- No need for a switchboard
- Easy and safe installation (low voltage device)
- Protected against short circuit
- Double temperature safety feature
- Control up to 160pcs fixtures
- Show output as W or %
- Auto shutdown at temperature setting

